

RPMGLOBAL DRAGSIM

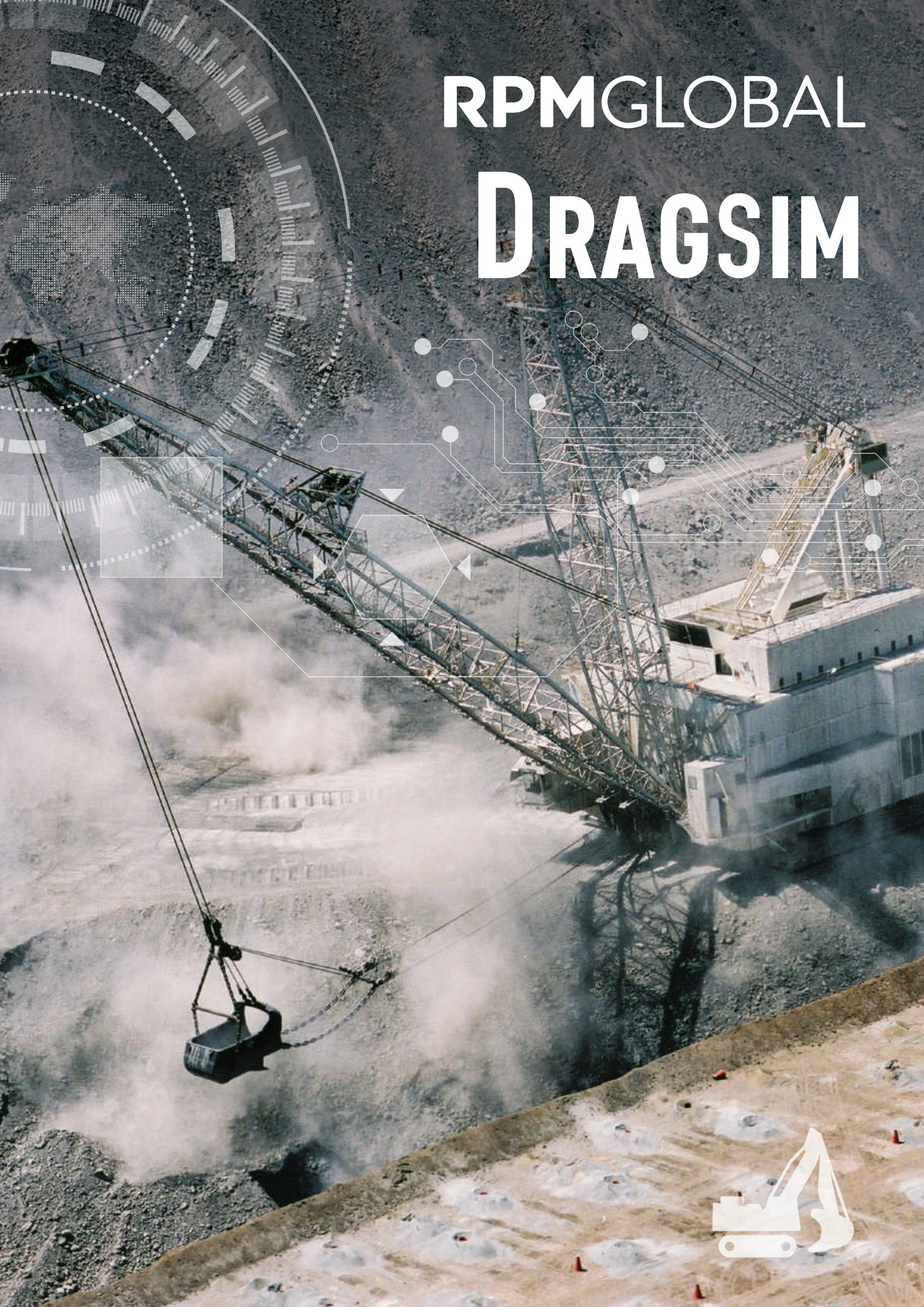

Whether you compare before spending, or compare before digging, DRAGSIM dragline simulation can help you find the right fit for your mine site. Mining engineers have trusted DRAGSIM for decades to make informed operational decisions, obtaining practical productivity and production cost data with speed and precision. DRAGSIM's fully auditable functionality makes it a great fit for your company's governance platform, you too can trust it to deliver accuracy and reliability from the pit to the boardroom.

*Before investing in a dragline,
invest in DRAGSIM.*

Benefits

Decision support

DRAGSIM is an advanced dragline simulation system designed to optimise equipment productivity and waste movement – have complete confidence in your decisions using DRAGSIM's decision support capability.

Method validation

By reproducing dragline methods across a range of operational parameters, and incorporating blasting, waste stripping and other mining equipment into the analysis, DRAGSIM gives users an accurate picture of dragline operations for a best-practice approach.

Evaluation of operating methods

Analyse the various segments of a cycle to identify the best and most practical method from a technical and economic perspective.

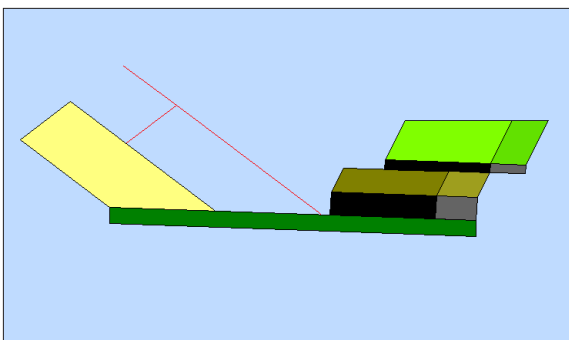

*Analyse and refine dragline
schedules to reduce operating costs
and maximise value.*

Features

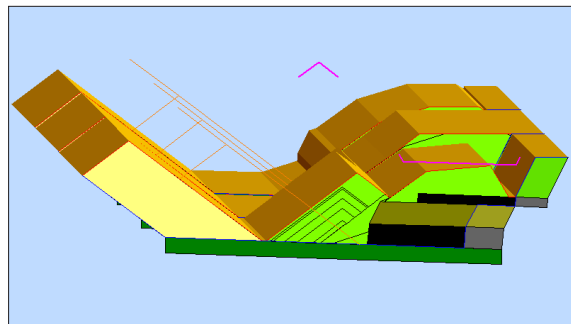

Simple, easy to use interface

Get the results you need quickly with minimal training and implementation costs. Most users are up and running in days.

Input real mine profile data

There is no limit to the amount of data that can be inputted into DRAGSIM for analysis. Users can quickly and easily run calculations and simulate productivity, re-handles, unit costs and volumes to ensure optimum dragline productivity.

Determine optimum outcome rapidly

Produce complete simulations of all facets of dragline operations to make informed decisions.

3D User interface

Users can visualise the simulation as it running. Visualise output pit cross-sections, rendered 3D views and sequences. Communicating simulation setup or the results of the simulation have never been easier.

Powerful analytics

Utilise DRAGSIM's powerful reporting capabilities to accurately analyse production costs and productivity levels to drive continuous improvement.

Enterprise Planning Framework

Enterprise integration and collaboration will deliver the operational improvements mining companies need to realise the next wave of productivity improvements. Whilst most mining companies have realised value implementing an integrated strategy in their Corporate functions, such as finance and HR, they have not extended this to their Technical Mining Operations (TMO). Consequently the TMO is a complex web of point solutions, data sources and silos that delivers complex structures and inadequate functional collaboration.

RPMGlobal's Enterprise Planning Framework (EPF) is a strategic platform that consumes and exchanges data from multiple sources including ERP, Business Intelligence (BI) tools, mine planning and command and control fleet management systems (FMS). It supports management processes, eliminates reliance on disconnected spreadsheets, individual departmental point solutions and fragmented BI technologies. Integrating the data delivers timely decisions-making as well as greater communication and visibility across the mining operations.



INTELLIGENT SIMULATION



About RPMGlobal

RPMGlobal is the global leader in the digital transformation of mining. We provide data with context, transforming mining operations. Our Enterprise approach, built on open industry standards, delivers the leading digital platform that connects the systems and information and seamlessly, amplifying decision-making across the mining value chain.

RPMGlobal integrates the planning and scheduling, with maintenance and execution, with simulation and costings, on RPM's Enterprise Planning Framework, the mining industry's only digital platform that delivers insight and control across these core processes.

RPMGlobal's Advisory Team advise the global mining

industry on their most critical issues and opportunities, from exploration to mine closure. Their deep domain expertise, combined with their culture of innovation, and global footprint, ensures our mining customers continue to lead.

RPMGlobal is the global leader in Enterprise mining software, Advisory services and Professional development who operate offices in 23 locations across 13 countries and have worked in over 118 countries.

For more information visit rpmglobal.com or email info@rpmglobal.com.