



RPM **INDONESIA 2023**
GLOBAL USER CONFERENCE

AGENDA

Tuesday 28th February 2023

Sheraton Grand Jakarta Gandaria
City Hotel

Event Information and Contacts

Welcome

Welcome to our Indonesia User Conference 2023. It has been two years since we last hosted this event, and we are excited to share our advancements in our technologies. We hope you enjoy the day!

Key Contacts



Blair Lucas

Senior Business Development Executive, APAC

📞 +61 439 001 829

✉️ blucas@rpmglobal.com

Blair's Virtual Business Card



Michael Baldwin

Regional General Manager, APAC

📞 +61 407 518 885

✉️ mbaldwin@rpmglobal.com

Michael's Virtual Business Card

Site Map

Level 3

Breakout Area -
Meals and Networking

Ruby Sapphire Room -
Main Room / Mine Planning Stream

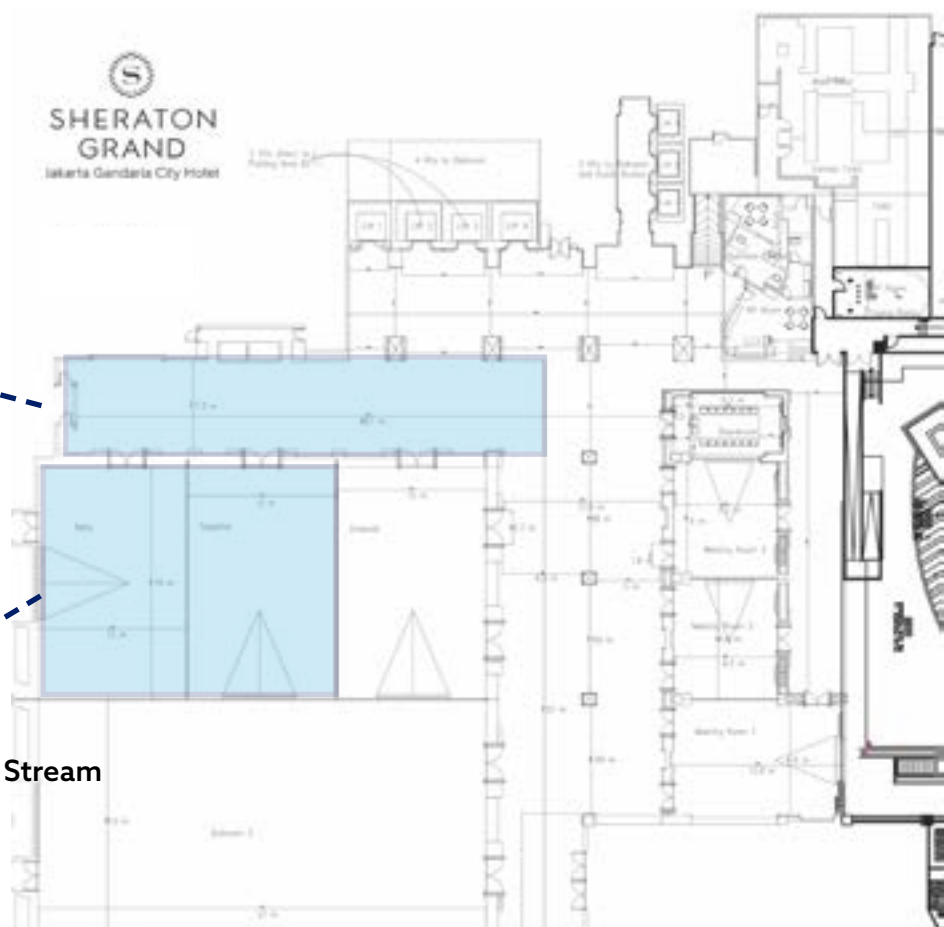

Level UG

Meeting Room 8 -
Asset Management Stream

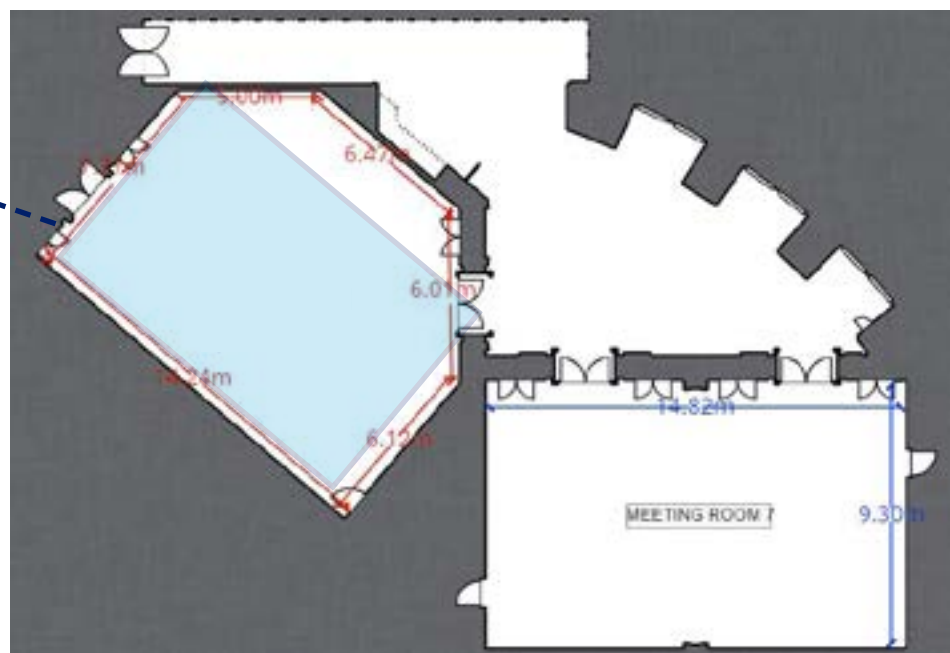

Main Room - Ruby-Sapphire Room

- 9:00am **Welcome to RPM's Indonesia User Conference 2023**
Join us for some light refreshments before presentations begin.
- 9:30am **Opening Address**
Michael Baldwin - RPM Regional General Manager, APAC
Join our Regional General Manager, as we kick-off our Indonesia User Conference.
- 9:45am **Company Strategy Update - Software Solutions**
David Batkin - RPM Executive General Manager, Product Strategy
RPMGlobal is a leading provider of Software Solutions to the mining industry with over 40 products currently available. David Batkin will give insight into where we are taking the products in the short term and our focus for the future.
- 10:15am **Break for Morning Tea**
Join us in the Ruby-Sapphire Room for some morning refreshments.
- 10:30am **Presentations begin for each stream**
- 12:30pm **Lunch**
Join us in the Ruby-Sapphire Room for a lunch break.
- 2:30pm **Break for Afternoon Tea**
Join us in the Ruby-Sapphire Room for some delicious afternoon snacks, tea and coffee.
- 4:30pm **Closing Remarks & Door Prize Draw**
Tim Knight - RPM President Director - Advisory Consulting
- 4:40pm **Networking Event**
We hope you can join us for the Networking portion of our event, light refreshments will be served.

The background of the entire slide is a photograph of a large, terraced quarry or open-pit mine. The rock faces show distinct horizontal layers. Overlaid on this image is a digital graphic consisting of numerous thin, vertical blue lines of varying heights, each topped with a small blue dot, resembling a data visualization or a stylized rain effect.

RPM
GLOBAL **INDONESIA 2023**
USER CONFERENCE

ASSET MANAGEMENT STREAM

Asset Management Stream - Meeting Room 8

10:30am **Improving Availability & Reliability**

Ian Sedgwick - RPM Product Manager, Asset Management

Using AMT's insights to improve an operations reliability and availability of assets. AMT's reporting and planning functions can be used to ensure maintenance is completed efficiently.

11:15am **Masterclass - Maintenance Cost Budgeting**

Ben Moran - RPM Asset Management Consultant

Maintenance budgeting is not a simple task, and yet many operations still rely on complicated Excel driven processes to drive it. During this session, our team will deliver a masterclass in Maintenance Cost Budgeting. Attendees will walk away with tips and advice to help with their next budget preparation period and deliver better budgets for their business.

12:00pm **Introducing AMT Mobile 2.0**

Ian Sedgwick - RPM Product Manager, Asset Management

This is the launch of our new mobile solution for both AMT and SAP environments. This solution has been developed with a Tier 1 miner and seamlessly integrates with ERPs to enable a digital checklist, inspections and much more. AMT Mobile 2.0 puts mobile capability into the hands of the users in the field!

12:30pm **Lunch**

Join us in the Ruby-Sapphire Room for a lunch break.

1:30pm **AMT Alumni Launch**

Michael Baldwin - RPM Regional General Manager, APAC

AMT celebrates its 20th anniversary this year, and it is no surprise that its use across the industry has grown massively to include a large base of users past and present. We will be launching a new Alumni program to enable these users to come together in a single AMT community.

Asset Management Stream - Meeting Room 8

- 1:50pm **AMT Roadmap Review**
Ian Sedgwick - RPM Product Manager, Asset Management
The last 12 months have seen a lot of new development, and we are not stopping! Our Product Manager will review the most recent developments and the value these new capabilities can deliver, as well as work through the roadmap for coming releases.
- 2:10pm **Power BI Reporting in AMT**
Ben Moran - RPM Asset Management Consultant
We take a look at a handful of new Power BI dashboards that utilise existing and new data available through AMT.
- 2:30pm **Break for Afternoon Tea**
Join us in the Ruby-Sapphire Room for some delicious afternoon snacks, tea and coffee.
- 2:45pm **Using AMT to Optimise your Inventory**
Ben Moran - RPM Asset Management Consultant
Inventory Optimisation usually involves historical actuals, spreadsheets and a lot of the time, gut feel! With AMT's ability to hold an accurate forecast, utilising this information can give you a far better optimisation and overall better inventory position. This session explores how this works in a real-world example.
- 3:05pm **Finding Value: True Benchmarking**
Ian Sedgwick - PRM Product Manager, Asset Management
Understand and analyse performance across the full lifecycle of equipment, by using benchmarking equipment performance and costs across fleets, sites and models.

Asset Management Stream - Meeting Room 8

3:35pm **The Hidden Value in AMT**
Ian Sedgwick - PRM Product Manager, Asset Management
Ben Moran - RPM Asset Management Consultant
See the features in AMT that are often forgotten but deliver a lot of value when used right.

4:00pm **AMT Use Cases**
Ian Sedgwick - RPM Product Manager, Asset Management
David Batkin - RPM Executive General Manager, Product Strategy
During this session our Product Specialist will detail use cases from global miners who use AMT.

End of Asset Management Presentations
Join us back in the Ruby-Sapphire Room

4:30pm **Closing Remarks & Door Prize Draw**
Tim Knight - RPM President Director, Advisory Consulting

4:40pm **Networking Event**
We hope you can join us for the Networking portion of our event, light refreshments will be served.



INDONESIA 2023
USER CONFERENCE

MINE PLANNING STREAM

Mine Planning Stream - Ruby-Sapphire Room

10:30am **XECUTE Roadmap Review**

James Kennon - RPM Product Manager, XECUTE

XECUTE has seen one of the biggest years in terms of releases. This session will recap on the key features added, then look at the next 12 months and the coming developments in architecture that will bring big gains for users.

11:20am **Masterclass - Blending**

Chet Fong - RPM Solution Architect

For an operation, blending is critical to delivering value; however often the planning is done in isolated spreadsheets and processes. Our blending masterclass explores how modern-day systems and truly integrated processes can deliver better results and far higher value to operations.

12:00pm **Re-defining Compliance Planning**

Chet Fong - RPM Solution Architect

This session explores why it is so hard to truly measure plan compliance using today's measurements and proposes a new method to improve plan compliance moving forward. (Originally presented at the AusIMM conference - Chet was awarded best presentation for this!).

12:30pm **Lunch**

Join us in the Ruby-Sapphire Room for a lunch break.

1:30pm **XPAC Solutions Roadmap Review**

Alun Philips - RPM Product Manager, XPAC Solutions

During this session we review the recent releases of XPAC Solutions as well as looking at what is coming in the near future.

Mine Planning Stream - Ruby-Sapphire Room

2:30pm **Break for Afternoon Tea**

Join us in the Ruby-Sapphire Room for some delicious afternoon snacks, tea and coffee.

2:45pm **Enterprise Optimiser**

Alun Philips - RPM Product Manager, XPAC Solutions

This session launches a game-changing new Software solution. If you are into optimisation, this session is for you! RPM's new Enterprise Optimiser delivers true Multi-Period, Multi-Site, Multi Product Optimisation! Come along to see how this solution can quickly add value to your operations.

3:05pm **Guest Speaker: Petrosea | Presented in Bahasa**

Alvian Nurrahman - Senior Mine Planning Specialist

Join our special guest, Petrosea, as they present on 'Integrated Dynamic Scheduling'.

4:00pm **Case Study - How Simulations Support ESG Decision Making | Presented in Bahasa**

Afdi Rahmandita - RPMGlobal Senior Mining Consultant

This session focuses on how the right simulation tool can increase mine productivity whilst helping operations reach emissions targets. HAULSIM is a Discrete Event Simulation solution that can be used to evaluate alternative scenarios with electric, hybrid and hydrogen fleets without any capital outlay.

End of Asset Management Presentations
Join us back in the Ruby-Sapphire Room

4:30pm **Closing Remarks & Door Prize Draw**

Tim Knight - RPM President Director - Advisory Consulting

4:40pm **Networking Event**

Are you a current user of RPM Software?

Sign up for RPM Connect to receive support and interaction with our customer success team, as well as access to our exclusive user community!

Scan or click the link below



rpmglobal.com/connect



RPM **INDONESIA 2023** GLOBAL USER CONFERENCE

THANK YOU FOR JOINING US

About RPMGlobal

RPMGlobal is the global leader in the digital transformation of mining. We provide data with context, transforming mining operations. Our Enterprise approach, built on open industry standards, delivers the leading digital platform that connects the systems and information and seamlessly, amplifying decision-making across the mining value chain.

RPMGlobal integrates the planning and scheduling, with maintenance and execution, with simulation and costings, on RPMGlobal's Enterprise Planning Framework, the mining industry's only digital platform that delivers insight and control across these core processes.

RPMGlobal's Consulting & Advisory Team advise the global mining industry on their most critical issues and opportunities, from exploration to mine closure. Their deep domain expertise, combined with their culture of innovation, and global footprint, ensures our mining customers continue to lead.

RPMGlobal is the global leader in Enterprise mining software, Consulting & Advisory services and Professional development who operate offices in 20 locations across 13 countries and have worked in over 125 countries.

For more information visit rpmglobal.com or email info@rpmglobal.com.